

Step-by-Step Instructions

Refillable Compatible Cartridges

(PRINT this set of instructions to follow every time you refill your cartridge)

Epson T068, T069, T078, T079, T088, T124, T125, T126 and T127 Refillable Compatible Cartridges

Read important chip resetting instructions at the end of this document before you refill.

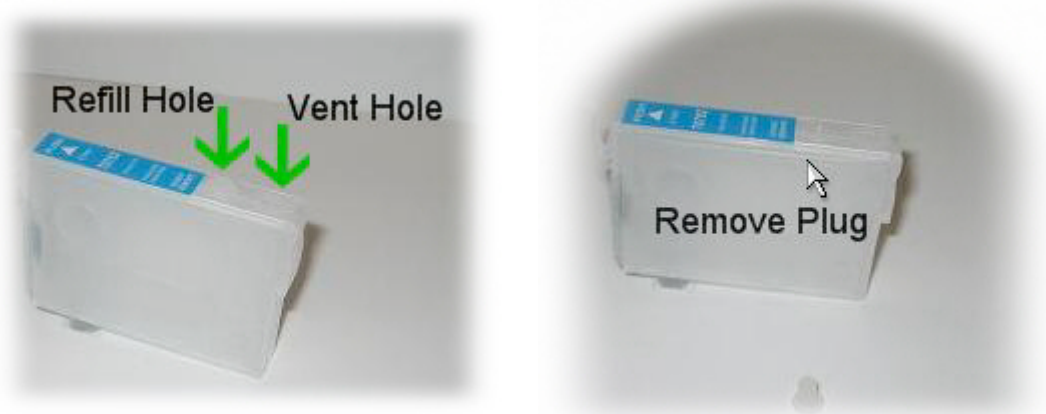

These refill instructions are for the Epson empty refillable cartridges. First buy a combo pack of empty refillable cartridges. These refillable cartridges come with no ink. These cartridges have an auto reset chip and do not need a chip resetter. Auto reset means, when the cartridge is removed, refilled, and replaced back into the printer the chip will read full again.

Important: Use all refillable cartridges together; do not mix them with Epson cartridges

1. Put the cartridge on some paper towels in an area where you can tolerate a spill.
2. Remove the white filler plug. This is your fill hole. Leave the color plug in the air vent hole until after your cartridge is full. Once cartridges are full remove the color plug and set aside. Leave the air vent hole open and unplugged.

Turn bottle upside down so just ink leaves the bottle and not any air. Do not squeeze air into the cartridge.

3. Insert the needle tip into the filler hole. S-l-o-w-l-y inject the ink into the filling hole of the cartridge until the cartridge is filled about ¼ inch for the top. Leave an air space at the top of the cartridge.

Holding the bottle upside down, it is 5 mls from the top to the first marker line and then 3 mls each marker line. The bottle has 65mls of ink.

The black cartridge will take up to approximately 14ml

Black cartridge takes Black Dye ink

The color cartridges will take up to approximately 14ml each

Yellow takes Yellow

Magenta takes Magenta

Cyan takes Cyan

For the T078

Light Cyan takes Photo Cyan

Light Magenta takes Photo Magenta

4. Replace the white filler plug and push it in so the cartridge is airtight.

5. Install the cartridge into the printer and remove the color air vent plug and set aside. Do not remove the plastic on the ink exit port. The printer will poke the hole in the plastic at the bottom of the ink exit port.

6. Run 1 - 3 cleaning cycles as per printer instructions.

Or print the following pages:

<http://www.inkonline.net/support/blackinktest>

<http://www.inkonline.net/support/colorinktest>

Troubleshooting:

Printers require you to replace with all refillable cartridges at one time. Otherwise the cartridges can not be detected by the printer. If the printer does not recognize the cartridges clean off the chip area with rubbing alcohol or cleaning solution. (You might have an oily finger print on the chip. Do not touch the chips with your fingers.) Another solution is to clean out the inside of the

printer and also make sure the cartridges are pushed all the way in so the printer can read the chip.

Chip Resetting information: It is also very important to reset the chips by turning the printer off then on when ink monitor indicates that the ink level is below 10%, and printer indicates that the cartridge is low (red light). Press ink exchange button (ink drop) when ink monitor indicates that the ink level is below 10%, and printer indicates that the cartridge is low (red light). **If the cartridge is refilled, but the ink monitor does not indicate that the cartridge is low, you will be unable to reset the chip until the ink monitor indicates that the cartridge is low.** For this reason it is best to refill the cartridges only when the cartridge is shown as low. Many users find it more convenient to have two sets of cartridges to precipitate a quick change over when a cartridge is reported empty.

AccuBrite, Inc. is not affiliated with the listed printer manufacturers or their subsidiaries. The use by AccuBrite, Inc. does not imply endorsement by or association with the brand name owners. The listed manufacturers, printers and cartridges are used only for the purpose of showing the compatibility of this AccuBrite, Inc. product. All other trademarks, brand names and logos referenced in or on this product are the property of their respective owners. This material is protected by the copyright laws of the United States and other countries. It is illegal to reproduce these instructions. It may not be reproduced, distributed, or altered in any fashion by any entity (either internal or external to AccuBrite), except in accordance with applicable agreements or contracts of licensing, without the express written consent of AccuBrite, Inc.