

# Step-by-Step Instructions

(PRINT this set of instructions to follow every time you refill your cartridge)

## Lexmark 18C0781 #1 / 18C0190 #2

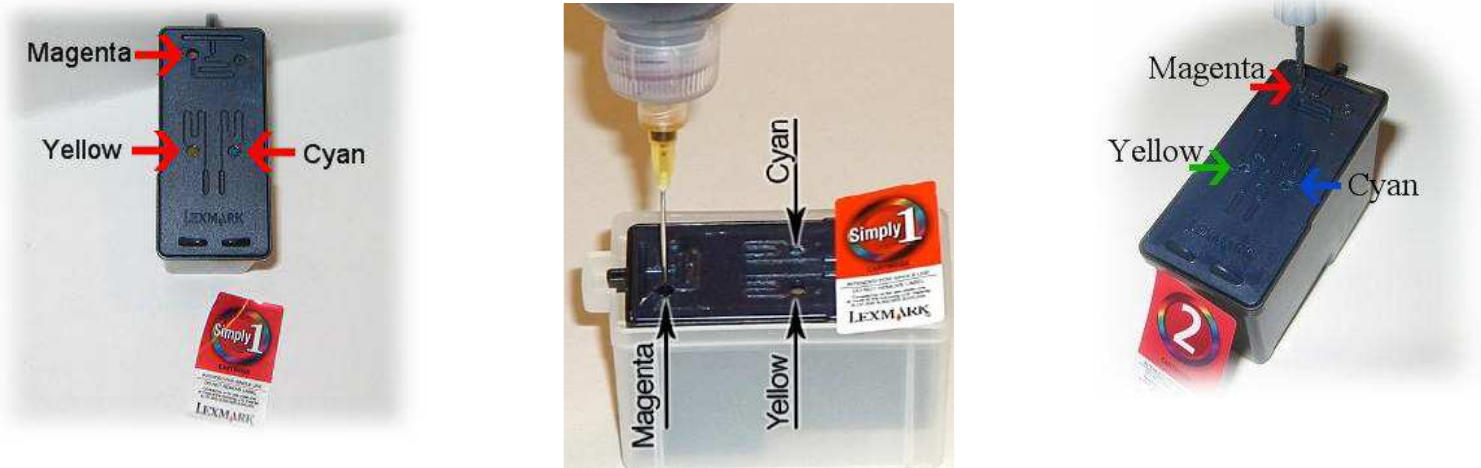

**Items needed: gloves, hand-drill, cyan, magenta & yellow inks, #6 refill station, paper towels, review hints & tips and check list. Do not plug fill holes.**

**Syringe: Attach needle tip (located inside station # 4) to the syringe tightly. Unscrew lid on ink bottle. Puncture silver seal with needle tip making a small hole in the center of seal. Using the correct color pull the correct amount of ink into the syringe. Rinse syringe and needle tip after every use and before using syringe with another color. Rinse syringe and needle tip with water until the water runs clear.**

Note: Follow the maze on the top of your cartridge to the small fill hole. There is a maze for each of the 3 fill holes. Make these holes bigger using the hand drill located inside station # 4 in your parts pack.

1) Place cartridge in Station #6 with copper circuits facing to the left and the plastic feet inside the bottom of the station to your right. **Do not use the refill station lid for refilling this cartridge.** Peel back the label on top of the cartridge. Under label are three holes. These are your fill holes. One by one, insert drill into each of the three holes and drill down into the inkjet cartridge. Make sure the drill goes thru the small hole making room for the bottle tip. You will have three fill holes for this cartridge. Rinse and dry drill after inserting into each color chamber. Fill holes with colors using picture as shown.

2) Insert correct color using the syringe deep inside the fill-hole. See picture and fill colors as shown. You may feel a slight pressure because the cartridge contains a sponge. (It's also a good idea to check the color chambers with a tooth pick before putting in ink. The chambers are somewhat dry and you might have to push the tooth pick in far to get ink on it.) S-l-o-w-l-y inject 6ml of color ink into fill-hole. **As you inject the**

**ink withdraw and re-insert the syringe at different angles in order to expose the whole sponge to the ink** A little ink might come out of the top when full, so cover up the other holes while filling one. If ink begins to “bubble” out of the fill-hole, remove bottle tip. Bubbling occurs when a cartridge is either over- filled or if ink is being inserted too quickly. Wait several minutes and then try to s-l-o-w-l-y insert more ink. If ink begins to bubble out the fill-hole or leak from the printhead, you have plenty of ink in the cartridge.

4.) After refilling, remove the cartridge from refill station. Without the cartridge “printhead” touching the paper towels, place the refilled cartridge upright upon folded paper towels and tilt cartridge at a slight angle. If the printhead on the cartridge is touching the paper towel, it could create a wicking effect that would pull the ink from your refilled cartridge. It is necessary for the cartridge to sit for at least 20 minutes after refilling because there maybe some minor leakage from the cartridge. Never put a leaking cartridge back into your printer.

**For best results, let cartridge sit for 8 hours after refilling so the ink can saturate the entire sponge.**

5.) Do not plug the fill-holes. If the fill-holes are plugged, a slight vacuum is created. This can result in interrupted print or no print.

6.) Check the ink flow by gently pressing a dry paper towel against the printhead. You should see three lines or dots of color ink. If not, gently press a warm, wet paper towel against the printhead until each color is visible.

7.) When the three colors are visible on paper towel, place cartridge back into the printer and run 1-2 print tests. **Or Print 3 pages using:**

[http://www.refills4you.com/support/black\\_print\\_test.html](http://www.refills4you.com/support/black_print_test.html) Black ink test  
[http://www.refills4you.com/support/color\\_print\\_test.html](http://www.refills4you.com/support/color_print_test.html) Color ink Test

Note: The cartridge will print just like a new one. Even though the cartridge prints well, the ink level gauge will not read full after a refill.

**PLEASE NOTE: If you have tried printing with your cartridge completely out of ink, you may have damaged the printhead. Inkjet printers work by heating a resistor inside the printhead which heats the ink before it is sprayed onto the paper. If there is no ink to keep the resistors cool, you stand the chance of frying them. In your worst case you will need to buy a new cartridge.**

**AccuBrite, Inc. is not affiliated with the listed printer manufacturers or their subsidiaries. The use by AccuBrite, Inc. does not imply endorsement by or association with the brand name owners. The listed manufacturers, printers and cartridges are used only for the purpose of showing the compatibility of this AccuBrite, Inc. product. All other trademarks, brand names and logos referenced in or on this product are the property of their respective owners. This material is protected by the copyright laws of the United States and other countries. It is illegal to reproduce these instructions. It may not be reproduced, distributed, or altered in any fashion by any entity (either internal or external to AccuBrite),**

**except in accordance with applicable agreements or contracts of licensing,  
without the express written consent of AccuBrite, Inc.**

**Copyright © AccuBrite, Inc. 2003-2008. All rights reserved**